

Cairfog instruction



[ACCESSORY]

- POWER CORD
- MANUAL

Electrical steam injector CF1901-TM110	
Voltage(V), Power(W)	110V, 1500W
Heater temperature	464~518°F (240~270°C)
Operating time	Approximately 8 minutes after pressing the start button (Preheating time may vary depending on season.)
Injection capacity	20ml/min
IP rating	IP x 4 (Protects from splashing water)
Maximum operating pressure	3 bar
Weight	5.7 lb (2.6 kg)
Distributor	VERICOM USA
Contact	Tel. 949-838-7871 / E-mail park@vericom.co.kr

[Configuration]

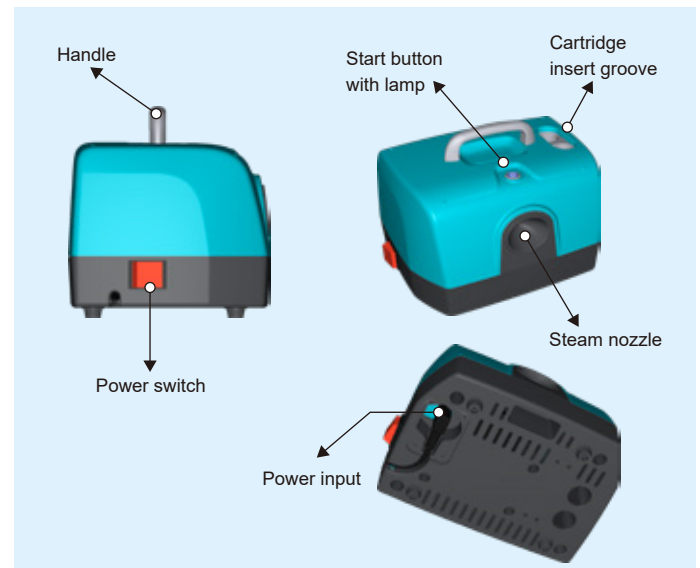

MODEL : CF1901-TM110

Safety precautions

1. Please read all the instructions carefully to ensure correct usage of the machine.
2. Do not spray directly toward humans and pets. Keep humans, pets, food and drinks out of the vehicle before placing the machine in the vehicle.
3. Use the handle and do not touch surface when the machine is hot. Do not let the power cable touch hot surface. Wait until the machine cools off to replace cartridges.
4. Do not immerse power cable, plug or machine in water or other liquid to prevent fire, electric shock and personal injury. Never leave the machine operating unattended.
5. Supervise closely the machine operation when children are near. Keep machine, cartridges and accessories out of the reach of children.
6. Unplug from the power outlet for cleaning or maintenance. Use only clean cleaning tools to clean the machine.
7. Do not operate the machine if the machine has malfunction or if any of machine/cable/plug is damaged in any manner. Do not open or disassemble the machine due to dangerous voltage inside. Keep the machine on a horizontal, stable and even surface.
8. Use only genuine accessories and cartridges supplied by manufacturer and distributor to prevent fire, electric shock and personal injury.
9. Do not use the machine for other purpose other than the originally intended use defined in this instruction.
10. Keep the machine and cartridges out of direct sunlight and humidity. Never place the machine near a hot subject such as radiator, oven, stove, open flame, etc.
11. Manufacturer assumes no responsibility for any damage from inadequate use, faulty operation, non-professional repair, incorrect voltage connection or failure to comply with the instructions.
12. In case of an emergency, damage or imperfect operation, immediately remove the plug from the power outlet and contact distributor for help. Damaged machine can cause electric shock and fire.
13. Plug the power cable only into suitable, easily accessible and grounded power outlet. Do not pull, clamp or hang the cable over sharp edges. Keep the cable away from heat and moisture. Do not pull on the cable. Pull the plug to unplug safely without damaging the cable. Never touch cable and plug with wet hands which can lead to fatal electric shock.
14. Make sure that the voltage of the power source is the same as specified on the rating plate.
15. Turn off the power switch first, then remove the plug from the power outlet to turn the machine off completely. Keep the machine disconnected from power supply when not in use for a long period.
16. All machines are subject to extensive and stringent quality control procedures. Reliability and validity tests under practical conditions are randomly performed on selected units. Some units may, therefore, show the traces of these tests.
17. Manufacturer reserves the right to change instructions at any time without prior notice.

Operating procedure

1. Start the engine and set the climate control system as follows: Air conditioner or heater (On), Lowest temperature, Wind direction (Front), Air intake (Internal circulation), Fan speed (Maximum air flow)
2. Connect the power cable to the power input socket of the machine and to the power outlet.
3. Turn on the power switch of the machine (Then the lamp of start button lights up, standby mode).
4. Open the cap off the cartridge but do not remove the sealing. Insert it into the cartridge insert groove of the machine and push it lightly.
5. Open the passenger door and place the machine on the floor (The steam nozzle toward engine compartment).
6. Press the start button on the machine and close all doors.
 - When the preheating is complete, the machine starts automatically and the lamp of start button blinks.
 - The operation time of the machine is about 8 minutes (Preheating time is slightly different by seasons). When the operation is complete, the machine automatically switches to standby mode (The lamp of start button is on).
 - When operation is complete, remove the machine from the vehicle, turn off the air conditioner, keep the ventilation mode active for about 10 minutes for the best effect.
7. Open all doors and ventilate the air in the vehicle completely.

· Overall Cairfog operation takes about 20 minutes.

· Maintain an interval of at least 10 minutes after three consecutive operations to prevent overheating of the equipment.